

OPTIMUS NEURO SURGERY

Plating System



**OSTEONIC**  
The Medical Explorer

# INTRODUCTION

Various clinical challenges surgeons are facing these days in Neuro Surgeries require solutions that can be only solved with innovative products.

Osteonic proudly meets these high demands, thanks to its cutting-edge development and manufacturing power coming from its key personnel with in-depth knowledge and experiences of more than two decades in products.

- ▶ Low profile of plate/screw minimize patient palpability
- ▶ Innovative Screw design allows for low insertion torque
- ▶ Rounded edges on plates decrease soft tissue irritation
- ▶ One blade fits for 1.5 screws
- ▶ Screw Container can be customized

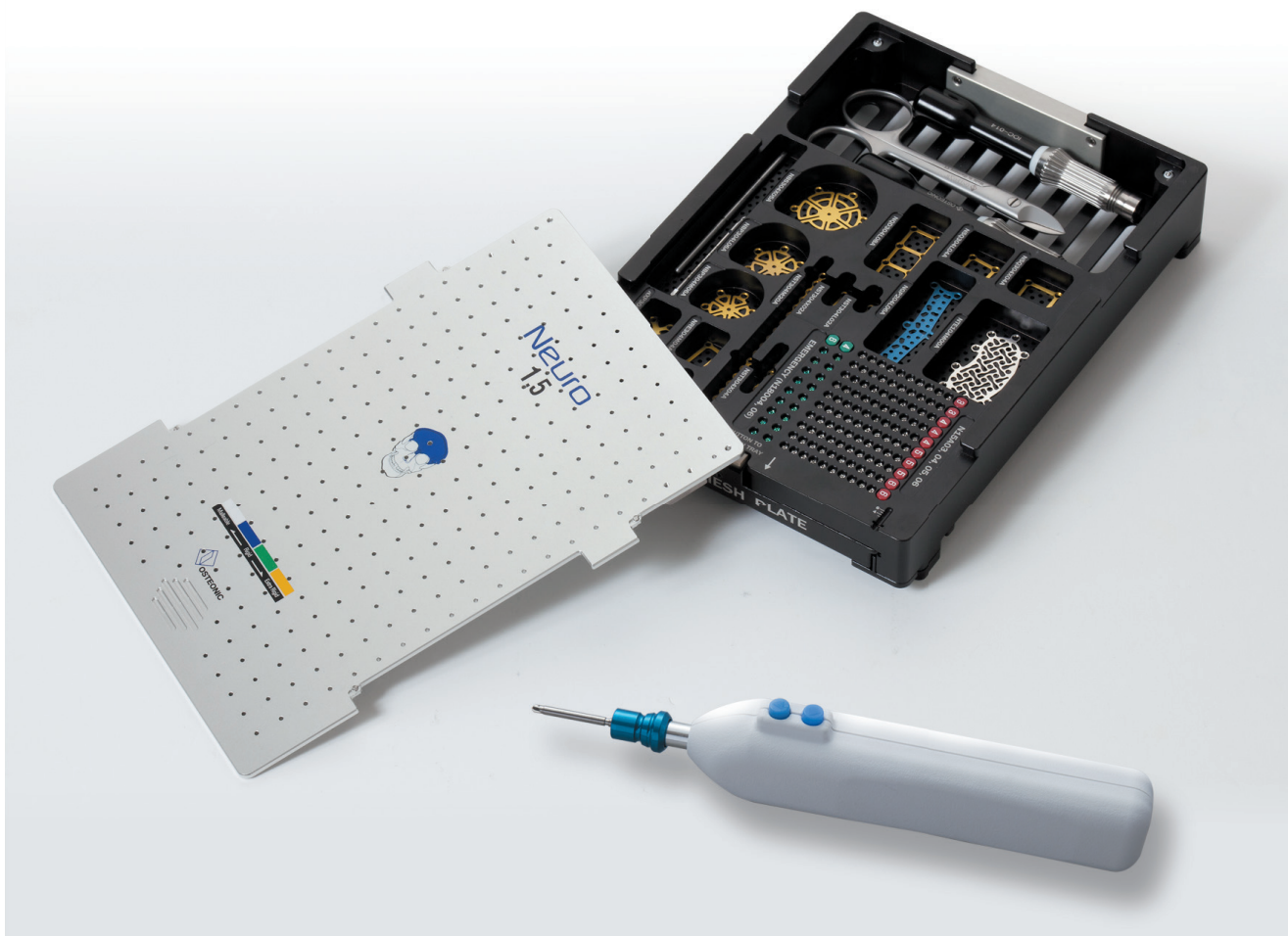

## INTENDED USE AND VARIETY OF INDICATION

Optimus Neuro System is intended for bone fixation and in the following indications;

- Craniotomies
- Cranial Trauma Repair and Reconstruction
- Cranioplasty
- Craniosynostosis

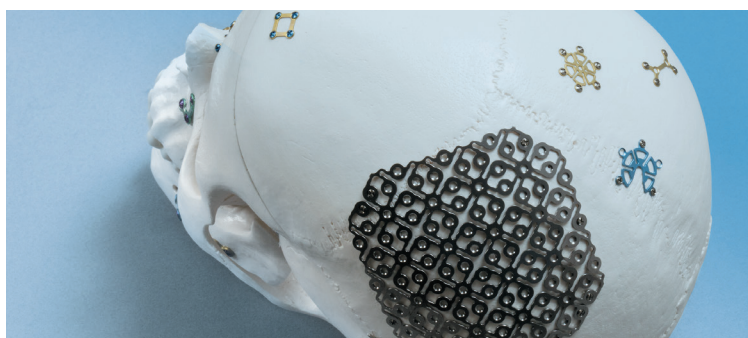
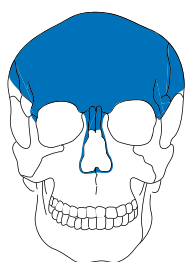

## SCREWS

- Low Insertion and High Pull-Out Torque
- Maximized Screw Blade Retention
- Low Screw profile

Description	Order No.	Φ	Size(mm)	Color
NEURO SCREW Self Drilling	N15A03	Φ 1.5	3	Grey
NEURO SCREW Self Drilling	N15A04	Φ 1.5	4	Grey
NEURO SCREW Self Drilling	N15A05	Φ 1.5	5	Grey
NEURO Emergency	N18004	Φ 1.8	4	Green
NEURO Emergency	N18006	Φ 1.8	6	Green

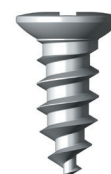

# PLATES

Straight Plate		(unit: mm)		
2holes / 0.4t		5 NST304M02A	9 NST304L02A	12 NST304X02A
4holes / 0.4t			NST304L04A	NST304X04A
5holes / 0.4t	NST304M05A	6holes / 0.4t		
8holes / 0.4t			NST304M06A	NST304M08A
10holes / 0.4t			NST304M10A	NST304M12A
12holes / 0.4t			NST304M12A	NST304M20A
20holes / 0.4t				
X Plate	Y Plate			
5holes / 0.4t	NXP304M04A	5holes / 0.4t		
		NYP304M05A		
D-Y Plate	6holes / 0.4t			
		NDY304M06A	NDY304L06A	
Square Plate	4holes / 0.4t			
	NRE304M04A	10 X 16 NSQ304M04A	12 X 12 NSQ304L04A	14 X 14 NSQ304X04A
				16 X 16 NSQ304M06A
Double Square Plate	6holes / 0.4t			
				10.6 X 20.6 NDS304M06A
Matrix Plate	8holes / 0.4t			
		12 X 28 NQD304M08A	14 X 34 NQD304L08A	
Burr Hole Calvarium Plate	6holes / 0.4t			
	8 NBC304S06A	15 NBC304M06A	24 NBC304L06A	

- ▶ Low Plate Profile
- ▶ For the most appropriate selection, a wide variety of plates and mesh are readily available

### Burr Hole Plate

(unit: mm)

6holes / 0.4t

12

15

17

24



NBP304S06A



NBP304M06A



NBP304L06A



NBP304X06A

### Burr Hole Plate Slot

5holes / 0.4t

12

15

17

24



NBS304S05A



NBS304M05A



NBS304L05A



NBS304X05A

### Gap Plate

6holes / 0.4t



NGP204S06A

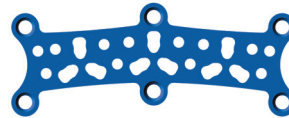

NGP204M06A

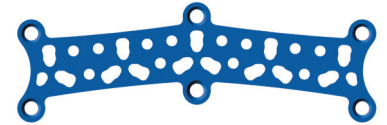

NGP204L06A

### Temporal Mesh

9holes / 0.4t

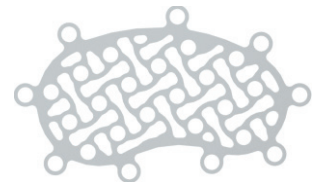

NTE104M00A

### Mesh Plate

(Scale: 50/100)

40\*25, 40\*50, 100\*75mm / 0.3t

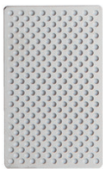

NME103S00



NME103M00

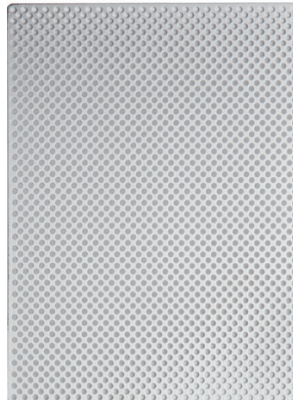

NME103L00

### 3D Mesh Plate

(Scale: 50/100)

50\*50, 100\*100mm / 0.6t

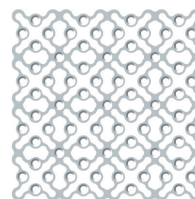

N3D206S00A

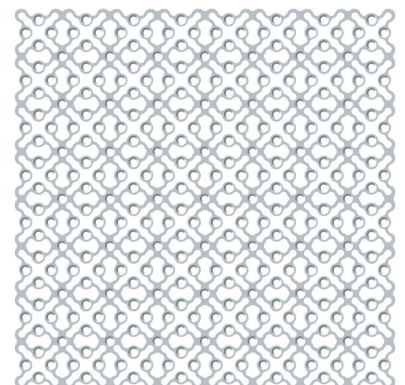

N3D206M00A

Plate & Mesh Tray

TPN-005

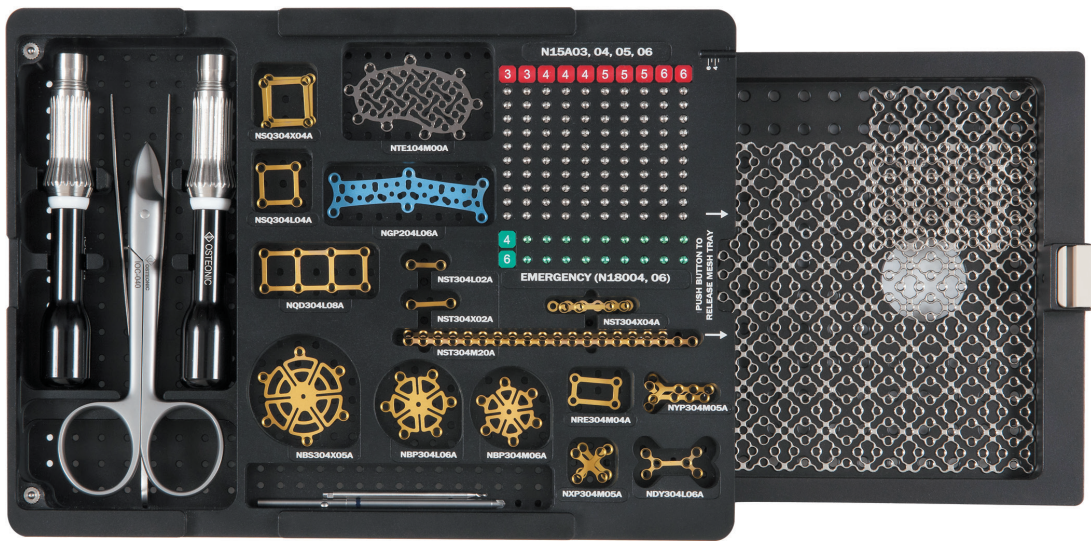

## Drill

ITEM	CODE	"D"	"L"	"A1"	mm
NEURO	NDB-01	Φ1.1	52	4	Drill Bit for Surgical

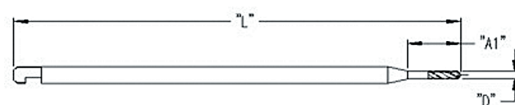

## Driver Shaft

Neuro Driver Shaft (75mm)	LDS-01
Neuro Driver Shaft for Power Driver(57mm)	LDS-02

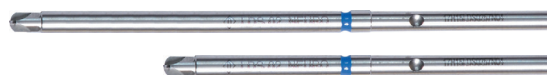

## Hand Driver Shaft Body

Hand Driver Shaft Body	IOC-014
------------------------	---------



## Forcep

IOC-032
---------



## Cutter

Plate Cutter / Neuro 1.5	IOC-040
Mesh Plate Cutter	IOC-041



CE  
1639



**OSTEONIC Co., Ltd.**

1206Ho, 38, Digital-ro 29-gil, Guro-gu, Seoul, Korea P.O. #08381  
TEL: +822 6902 8400 FAX: +822 6902 8401 [www.osteonic.com](http://www.osteonic.com)

NS - E - 2005